

17 Pacific Heights Court, Coolum Beach

Impressive Family Home with Premier Address and Elevated Views

Sweeping panoramic views North to Noosa and incorporating the stunning hinterland ranges and Mount Ninderry, this impressive family residence promises a beachside lifestyle and convenience. Its premier Coolum address is within walking distance of Coolum's restaurants, cafes and beautiful beaches. The pathway via Greenoaks Drive provides access to Coolum's patrolled beach in minutes. Designed to take full advantage of an idyllic northerly aspect and stunning hinterland views, the open plan living... for more information please visit our website

Water Rates: \$375 per quarter

Council Rate: \$2,214 per year

Disclaimer: In preparing this brochure, Coolum Beach Real Estate and it's related franchisees has relied in good faith upon information provided by others and has made all reasonable efforts to ensure that the information is correct. The accuracy of the information provided to you (whether written or verbal) cannot be guaranteed. If you are considering this property, you must make all

4 BED | 2 BATH | 2 CAR

SOLD
\$1,850,000



Kris McCartney 0438 403 642
kris@coolumbeach-realestate.com.au

enquiries necessary to satisfy yourself that all information is accurate.

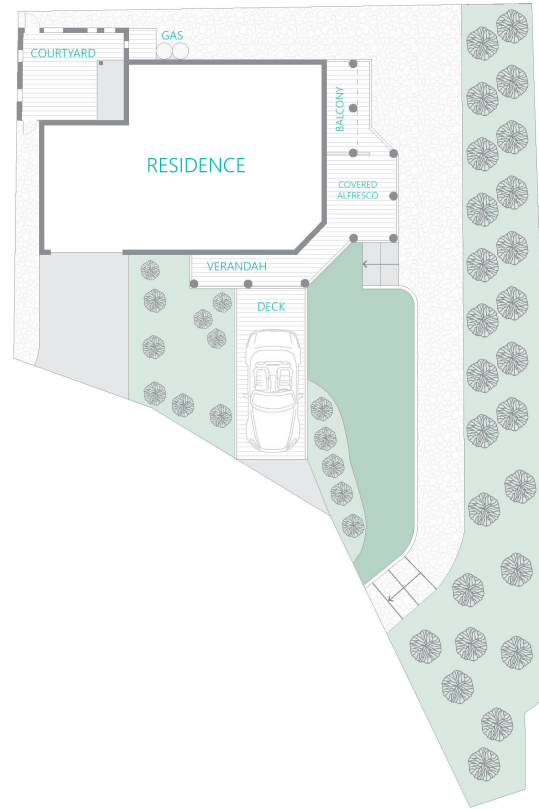
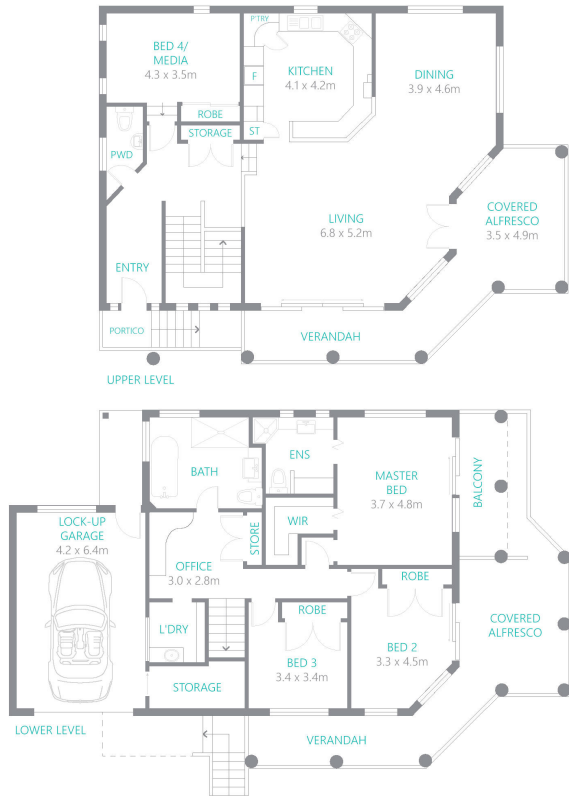

INTERNAL: 241m² EXTERNAL: 75m² TOTAL: 316m²

